

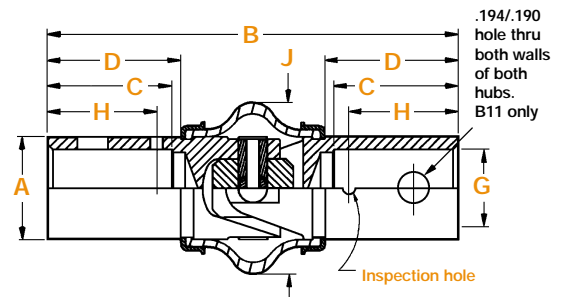

MS 271 Series

- Heavy-duty MS 271 military standard universal joints have undergone qualification testing and meet or exceed the requirements of Military Specification MIL-J-6193 and Standard Drawing MS20271.



MS 271 Series

Part Number	A +.000, -.002 (+.000, -.051) Outside Dia.		B +/- .015 (+/- .381) Overall Length		C +.031, -.000 (+.787, -.000) Bore Depth		D Min		G +.004, -.001 (+.102, -.025) Bore Diameter		H +/- .015 (+/- .381) Insp. Hole Loc.		J Max Dia. (+.102, -.025) Cover Dia.		L +/- .015 (+/- .381) X-Hole Loc.		Weight Max	
	in	mm	in	mm	in	mm	in	mm	in	mm	in	mm	in	mm	in	mm	Lbs.	kg

Dimensions

MS-20271-B6	0.372	9.45	2.000	50.80	0.500	12.70	0.563	14.30	0.250	6.35	0.437	11.10	0.781	19.84			0.07	0.032
MS-20271-B8	0.495	12.57	2.625	66.67	0.625	15.88	0.688	17.48	0.375	9.52	0.562	14.27	1.031	26.19			0.09	0.041
MS-20271-B10	0.620	15.75	2.750	69.85	0.750	19.05	0.813	20.65	0.500	12.70	0.687	17.45	1.156	29.36			0.18	0.082
MS-20271-B11	0.620	15.75	2.750	69.85	0.750	19.05	0.813	20.65	0.500	12.70	0.687	17.45	1.156	29.36	0.312	7.92	0.18	0.082
MS-20271-B12	0.745	18.92	3.187	80.95	0.875	22.22	0.938	23.83	0.625	15.88	0.812	20.62	1.437	36.50			0.24	0.109
MS-20271-B14	0.870	22.10	3.625	92.07	1.000	25.40	1.063	27.00	0.750	19.05	0.937	23.80	1.562	39.67			0.35	0.159
MS-20271-B16	0.995	25.27	4.062	103.17	1.187	30.15	1.188	30.18	0.812	20.62	1.062	26.97	1.906	48.41			0.55	0.250
MS-20271-B20	1.245	31.62	4.625	117.47	1.125	28.57	1.313	33.35	1.062	26.97	1.125	28.57	2.187	55.55			0.90	0.409
MS-20271-B24	1.495	37.97	5.250	133.35	1.312	33.32	1.438	36.53	1.250	31.75	1.250	31.75	2.750	69.85			1.50	0.682

Part Number	Angle	Torsional play			Minimum Ultimate Static Torque				Axial Tension & Compression		Endurance Torque Tests		
		Test Torque		Maximum Degrees	Specifications		Apex Average		Lbs.-in	N	Operating Angle	Torque	
		Lbs.-in	N-m		Lbs.-in	N-m	Lbs.-in	N-m					

Performance Specifications

MS-20271-B6	0	4	0.452	0.83	200	22.60	275	31.08	500	2,224	15°	30	3.39
MS-20271-B8	0	4	0.452	0.62	600	67.80	675	76.28	1,000	4,448	15°	90	10.17
MS-20271-B10	0	4	0.452	0.50	1,080	122.04	1,200	135.60	1,500	6,672	15°	162	18.31
MS-20271-B12	0	4	0.452	0.42	1,900	214.70	2,100	237.30	2,000	8,896	15°	285	32.21
MS-20271-B14	0	8	0.904	0.36	3,000	339.00	3,500	395.50	3,500	15,568	15°	450	50.85
MS-20271-B16	0	8	0.904	0.32	4,700	531.10	5,500	621.50	5,700	25,354	15°	705	79.67
MS-20271-B20	0	8	0.904	0.24	9,500	1,073.50	10,500	1,186.50	7,000	31,136	15°	1,425	161.03
MS-20271-B24	0	8	0.904	0.20	14,500	1,638.50	15,500	1,751.50	9,000	40,032	15°	2,175	245.78